

K-FUN Tastiera capacitiva

K-FUN Capacitive Keyboard



K-FUN - Capacitive Keyboard

FEATURES and OPERATION

- Power supply voltage: 13.8Vdc
- Rated current: 40mA ➤ Maximum current: 180mA ➤ Compatible with:
 - C24 gsm control unit with audio support in keyboard
 - Series S (S412 – S840 – S8128). **VOICE option in keyboard NOT supported**
 - Series C (C16 – C40, C288, C72GSM) **VOICE option in keyboard NOT supported**
- Automatic selftest system
- Touch-sensitive key enabling system with capacitive system
- Adjustable key DELAY AND SENSIBILITY
- Automatic keyboard lock (to prevent accidental enabling)
- Integrated transponder reader compatible with all the above-mentioned control unit models ➤ Addresses adjustable from the menu without the use of mechanical dip-switches ➤ Adjustable backlighting
- Adjustable contrast

- Key ID plate replaceable with other types.
- Buzzer for sounder input and output time
- Jumper to disable switch tamper
- **Audio EOL (End-of-Line) jumper to reduce noise on the sound line** ➤ Signaling LED:
 - Green LED on: system ready (all areas closed)
 - Red LED on: new event to be read in event log
 - Yellow LED on: control unit activated
 - Blue LED: signal of transponder operation enabled

FASTENING AND CONNECTION

To detach the rear part of the keyboard, act on the fastening tabs (in the lower part, after having removed the lock screws).

- When fastening the rear part, be careful with the removable element, if you want to have increased anti-removal protection, you must fasten it to the wall with a screw, which will keep the tamper switch of the keyboard pressed.
- Connect the power supply wires and the data following the polarities indicated in the terminal board.

This task must be carried out with no power supply.

- For the audio part, a conductor must be connected (**external to the data cable**) from the PHONE terminal (see instructions in the manual of the installed control units).
- In the back of the keyboard there is a jumper, used to apply the EOL heater on the keyboards with audio support. ***IT IS IMPORTANT THAT DURING CONNECTION WITH MULTIPLE KEYBOARDS used with Audio function, at least one have the EOL Jumper closed. In the case only one keyboard is used, the jumper must be closed.***
- Close again, laying the upper front part of the keyboard on the clips on the top part of the bottom (see drawing).
- Lock the bottom and front part into place with the included screw.

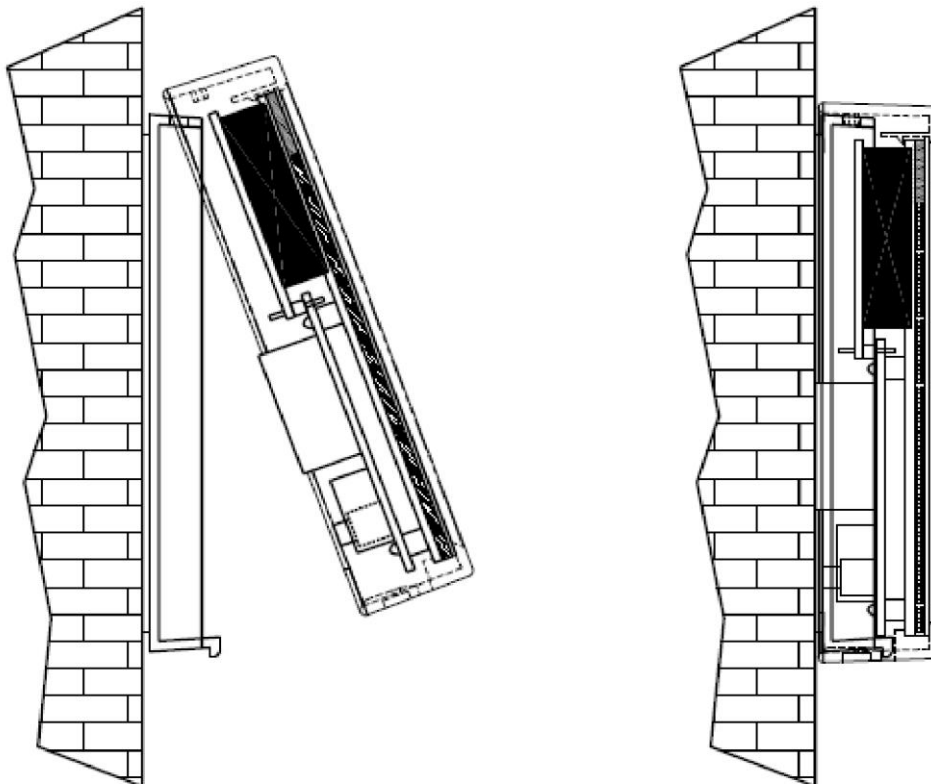

REPLACING THE FRONT COVER

In case you wish to replace the front cover, after having removed the rear part of the keyboard, remove its electronic part by acting on the 2 fastening tabs (see drawing). Remove the old cover and assemble the new one and the electronic circuit, following the steps indicated in the drawings below.

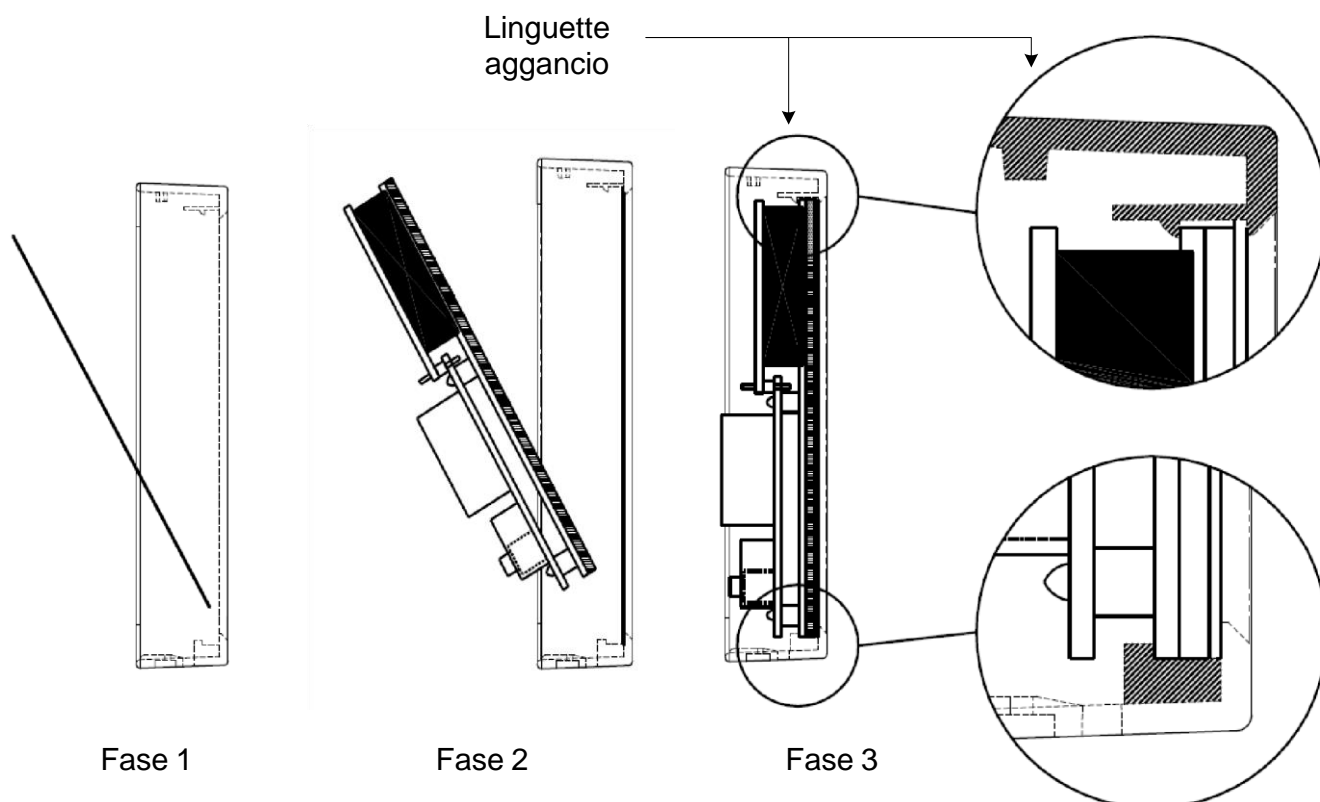

Step 1 = assembly of new cover

Step 2 = assembly of electronic board → Caution: the “glass slide in plastic” must be positioned all the way to its limit stop on the electronic board

Step 3 = locking of the electronic board → the electronic board must stay locked tight by the specific fastening tabs (see drawing).

Keyboard adjustments.

To access the menu of the parameter settings of the Keyboard, simultaneously touch the “X” and “V” enter symbols.

Use the UP and DOWN arrow keys to scroll through the:

- **Keyboard ID** (to set the hardware address of the Keyboard) → With the Right and Left arrow keys, set a value between 01 and 16 (default: 1)
- **Transponder ID** (to set the hardware address of the Transponder) → With the Right and Left arrow keys, set a value between 01 and 16 (default: 1)
- **Display Brightness** (to set the Brightness of the Display) → With the Right and Left arrow keys, adjust the parameter until you have the desired brightness. Value between 01 and 16 (default: 16).
- **Display Contrast** (to set the Contrast of the Display) → With the Right and Left arrow keys, adjust the parameter until you have the desired contrast. Value between 01 and 15 (default: 15)

- **Keyboard Delay** (to set the response time when you touch the “keys”) → With the Right and Left arrows, adjust the parameter; value between 1 and 4 (default: 2).
- **Keyboard Sensibility** (to set the sensibility of the “keys” when you touch them)→ With the Right and Left arrow keys, adjust the parameter; value between 1 and 4 (default: 2).
- **Connected Control Unit Type** (to set the type of control unit to which the keyboard connects) → With the Right and Left arrow keys, select the control unit
- **Lock Keyboard** (to set the automatic keyboard lock) → With the Right and Left arrow keys, select YES or NO (default: NO). With the lock enabled, after about 2 min. of disuse, the keyboard enters locked mode. Unlock with the DEL (X) and ENTER (V) keys touched simultaneously for a few seconds.
- **Keyboard Test** (to run a test on proper operation of all the “keys”)→ confirm with ENTER and then “test” all the keys. At the end of the test, press ENTER again.

L'installazione deve essere eseguita a regola d'arte da personale specializzato.

AMC Elettronica S.r.l. declina ogni responsabilità nel caso in cui il prodotto venga manomesso da persone non autorizzate.

Si raccomanda di verificare il corretto funzionamento del sistema d'allarme almeno una volta al mese, tuttavia un sistema di allarme elettronico affidabile non evita intrusioni, rapine, incendi o altro, ma si limita a diminuire il rischio che tali situazioni si verifichino. In caso di riscontro incongruenze su manuali pregasi contattare immediatamente assistenza tecnica AMC Elettronica S.r.l.

Installation must be carried out to state of the art by specialized staff.

AMC Elettronica S.r.l. rejects any responsibility in the case that the product is tampered with by unauthorized persons.

We recommend that you check that the alarm control unit is operating properly at least once a month; however, a reliable electronic alarm system does not prevent break-ins, thefts, fire, or other, but only limits itself to reducing the risk of such events actually occurring.

In case you notice mismatches in the manuals, you are kindly asked to immediately contact the customer service of AMC Elettronica S.r.l.